

Residential, self consumption 230VAC

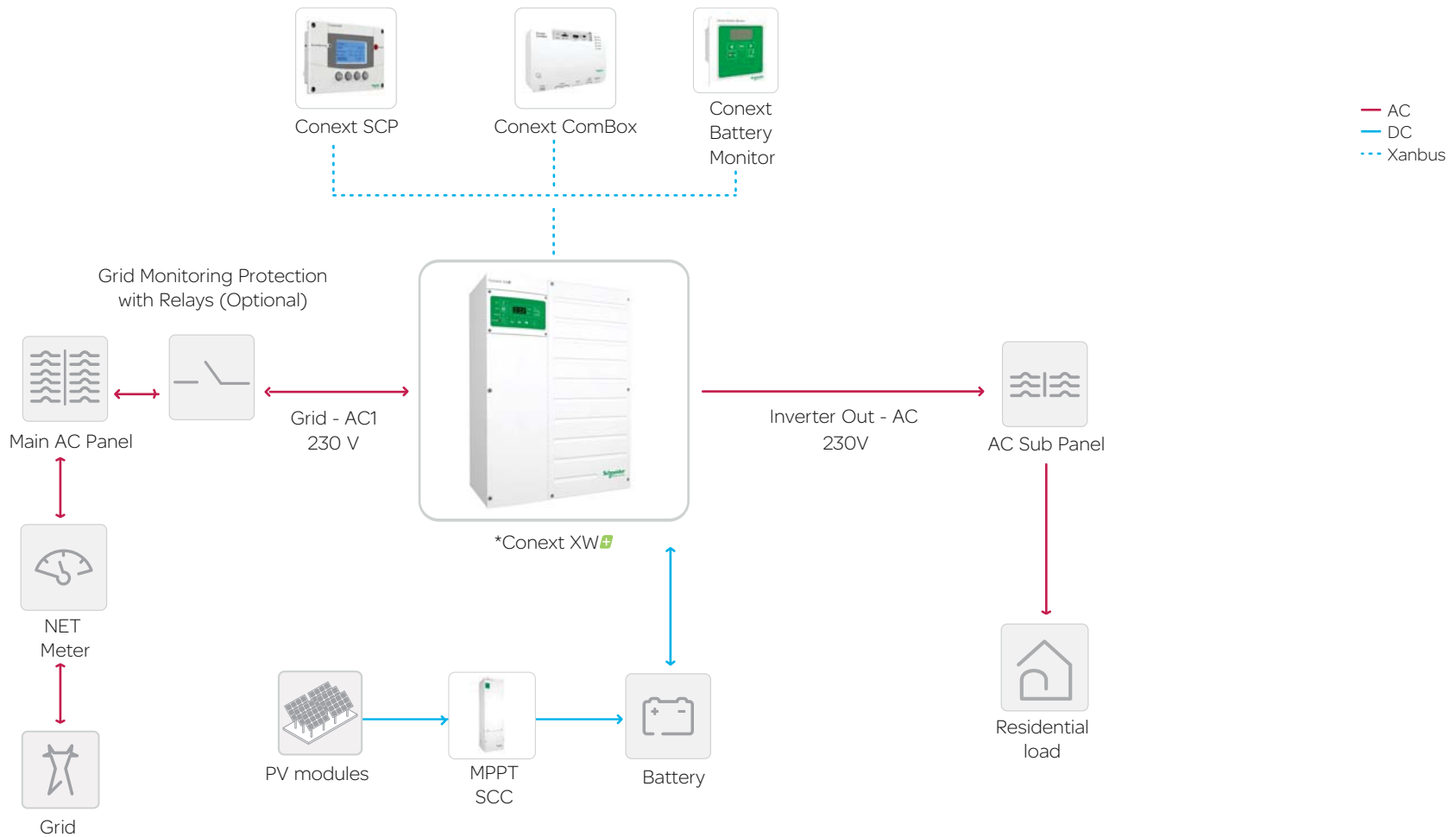

*230 VAC solution with Conext XW+ 7048 (5.5 kW continuous backup, max 4.6 kVA sell) or Conext XW+ 8548 (6.8 kW continuous backup, max 6.2 kVA sell)

Priority Power: The consumption of solar power or battery power is prioritized before purchasing power from the utility.

- Enhanced Grid Support set up enables power from Solar Charge Controllers to be converted to AC power supplementing grid input, excess AC power can also be sold to the grid where permitted.

Grid Sell: With Grid Sell enabled, Conext XW+ will export energy to the utility and is therefore required to be compliant with local grid export regulations, check with local authorities to confirm compliance.

- Grid Sell maximum is adjustable.

Grid monitoring Protection: Network and system protection for monitoring the power feed-in and coupling relays are required in some jurisdictions for compliant interconnection with the grid, check with local authorities to confirm requirements and compliance.